

Platform
44" x 82"
4" & 6" Ledges

Scale: 4' per inch

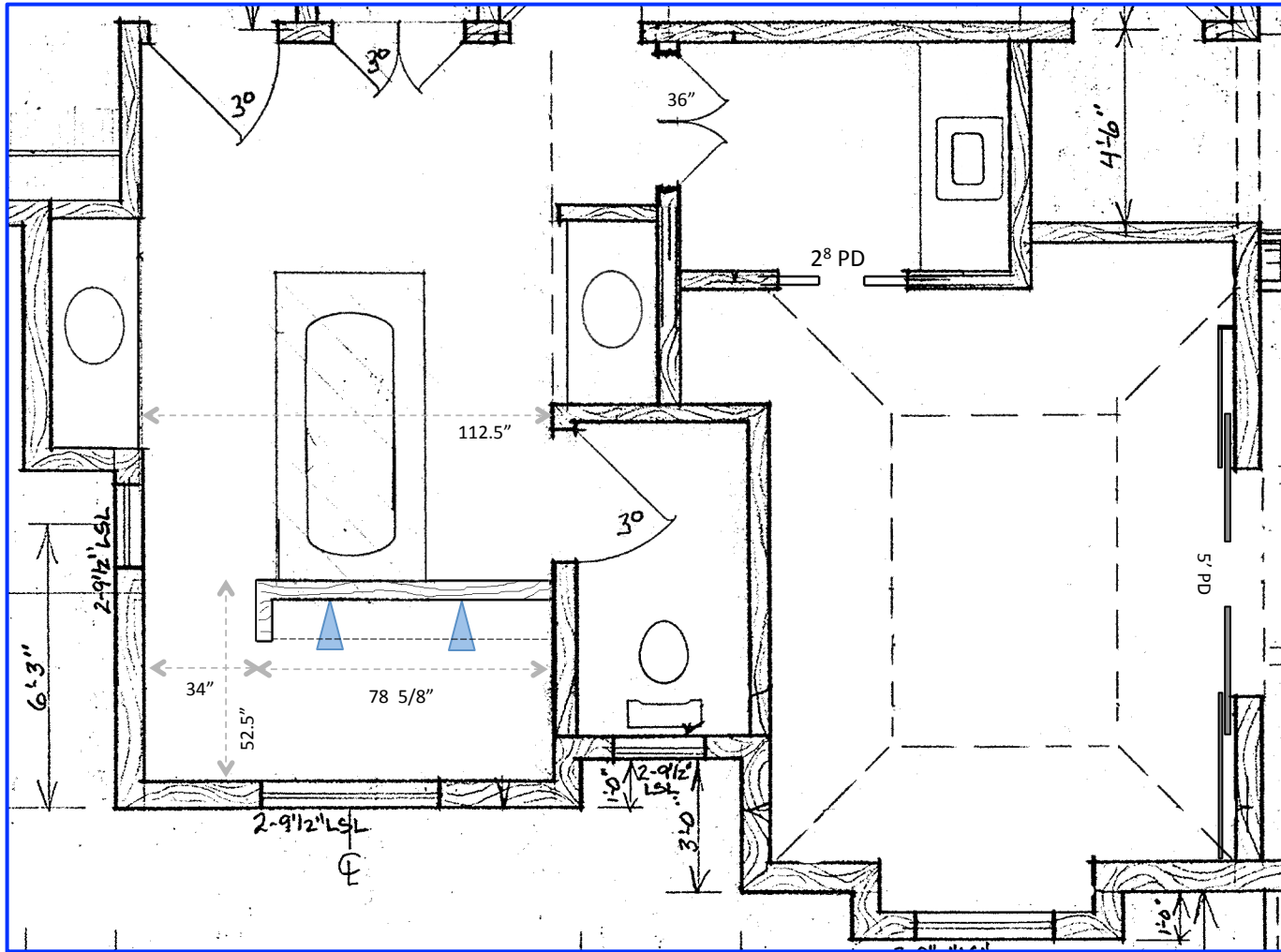

Scale: 4' per inch

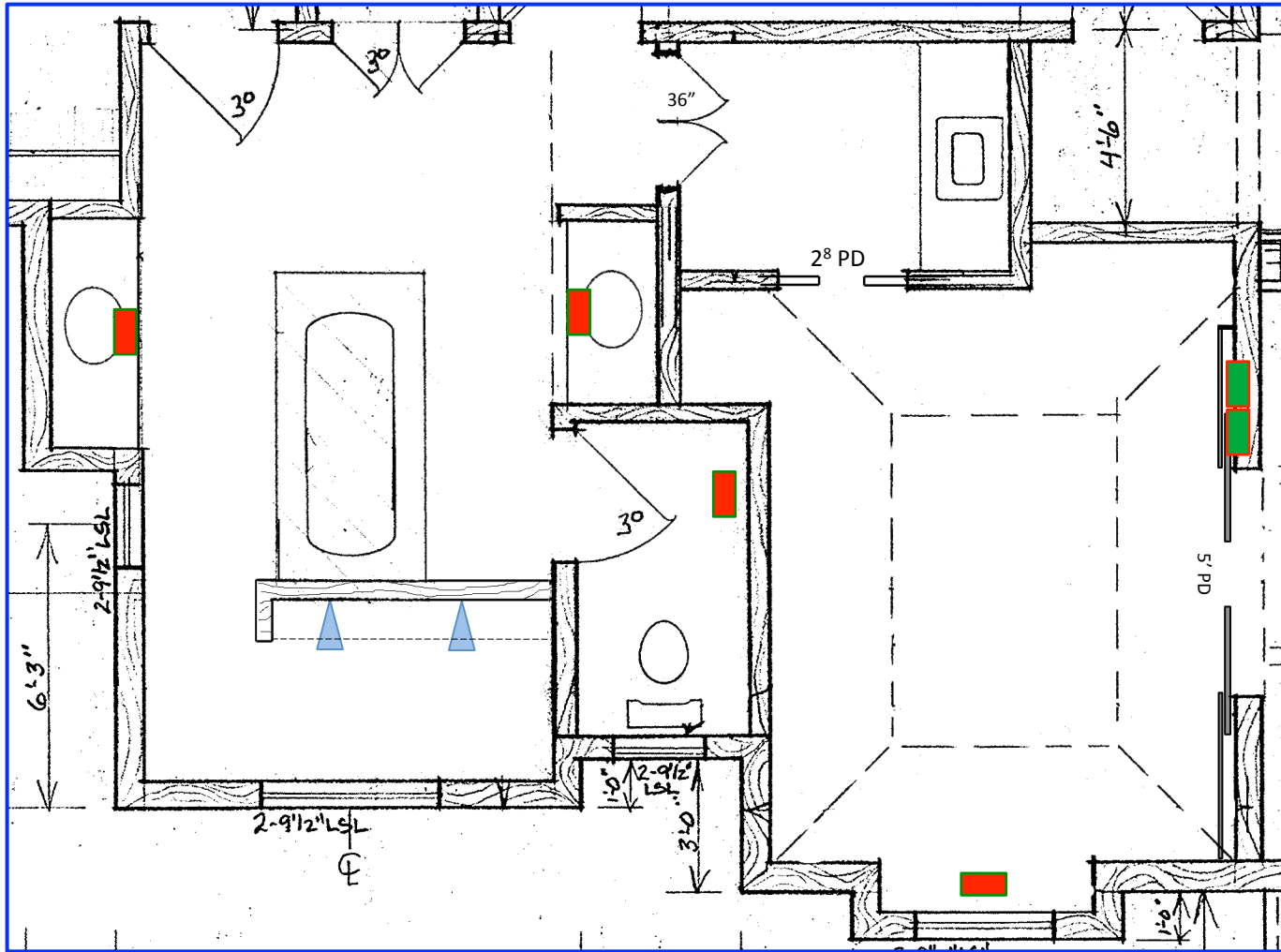

HVAC Duct Locations

■ = Supply Air Duct
■ = Return Air Duct

Scale: 4' per inch

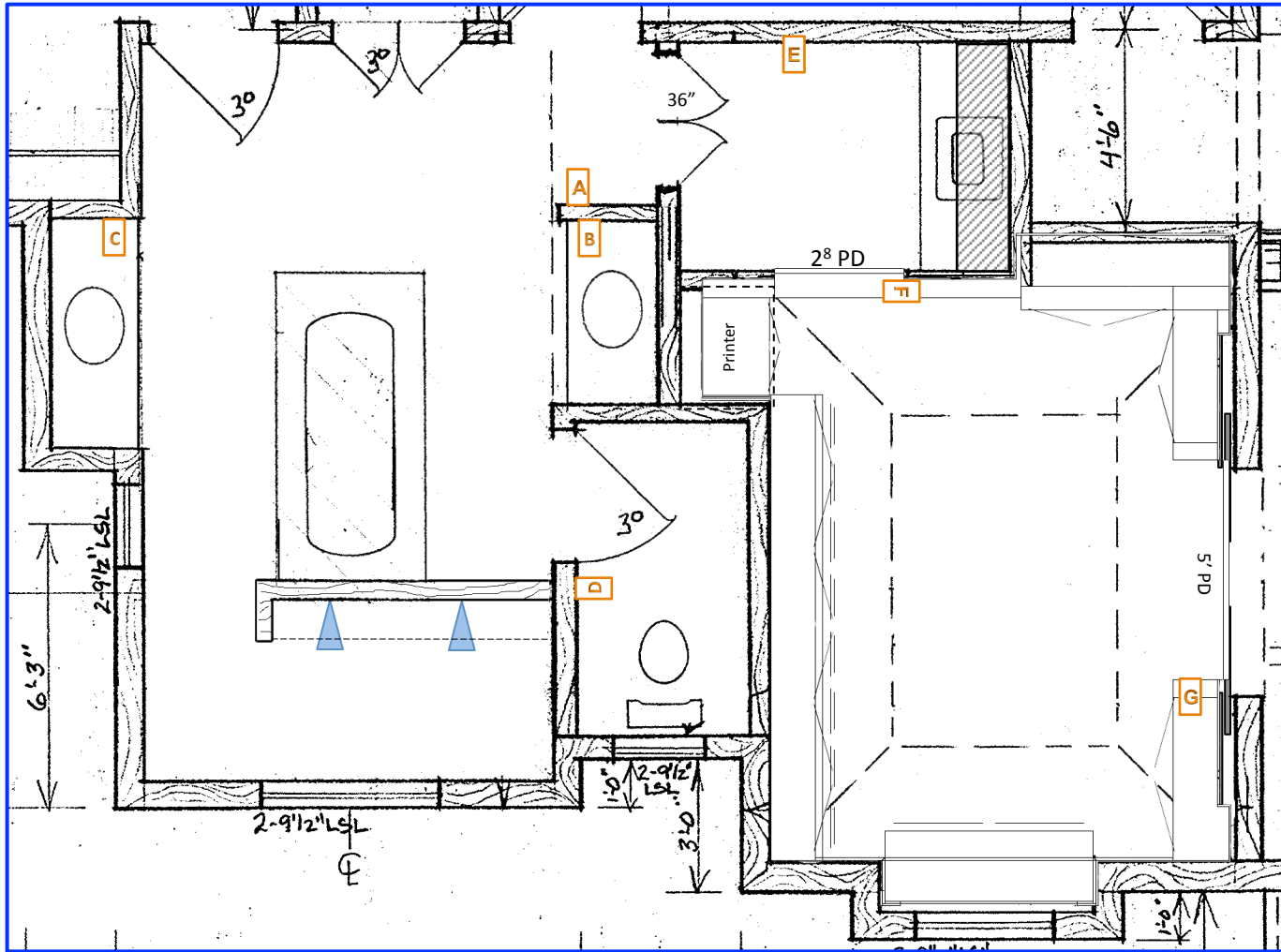

Lighting Controls

X = Switch Cluster

Scale: 4' per inch

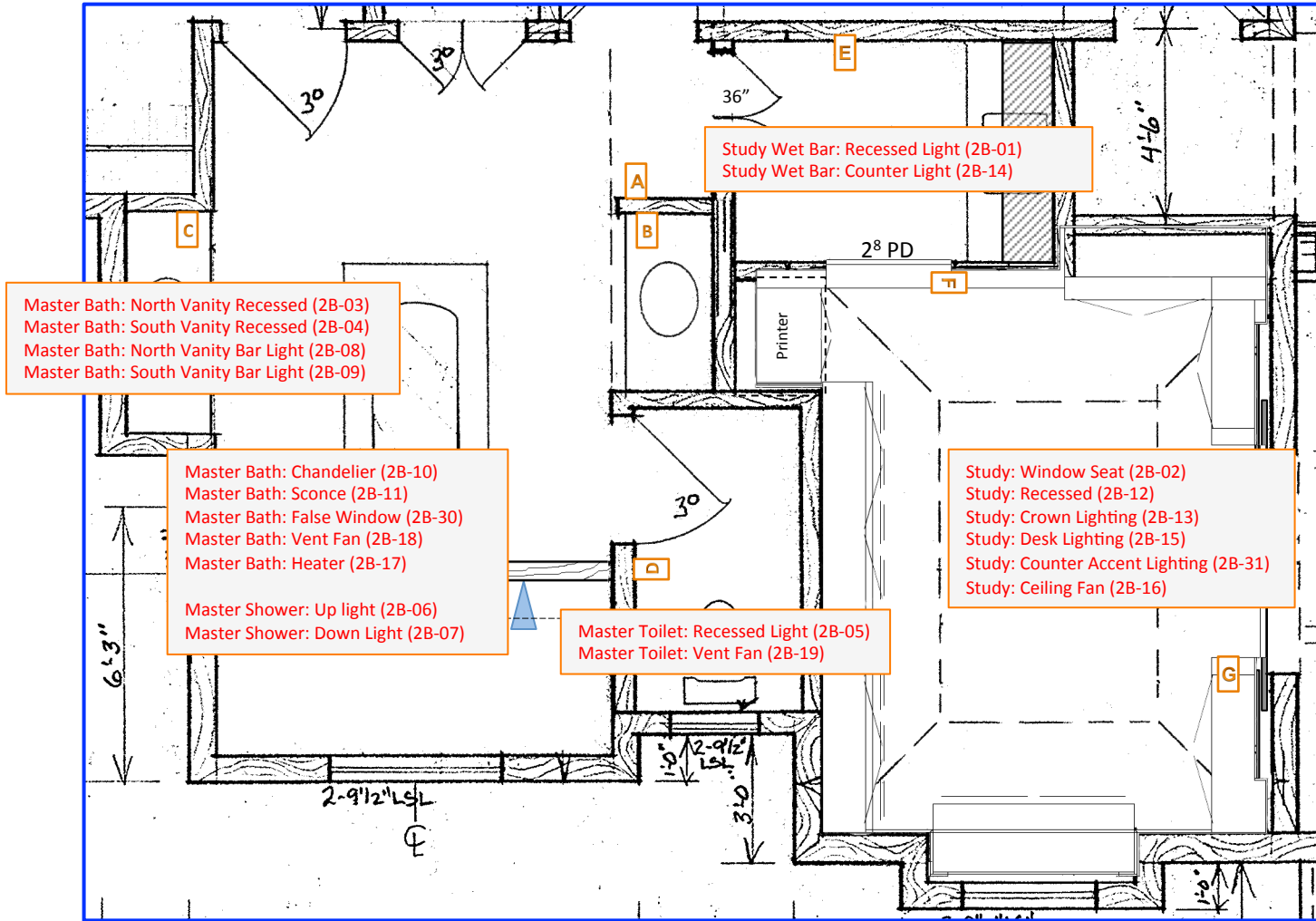

Lighting Controls

X = Switch Cluster

Scale: 4' per inch

Keypad Location 2B-A
Master Bath

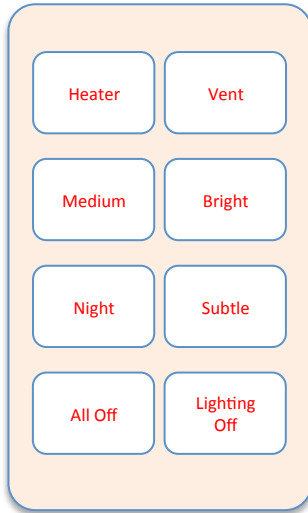

Master Bath: Chandelier (2B-10)
 Master Bath: Sconce (2B-11)
 Master Bath: False Window (2B-30)
 Master Bath: Vent Fan (2B-18)
 Master Bath: Heater (2B-17)

Master Shower: Up light (2B-06)
 Master Shower: Down Light (2B-07)

Cables
2 - Red/2

Keypad Location 2B-B
North Vanity

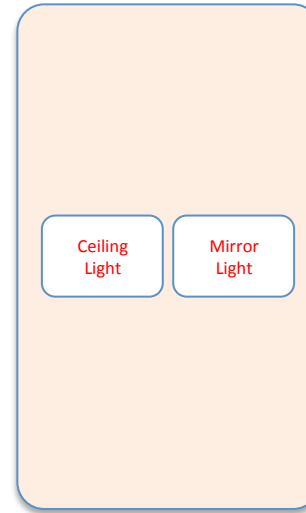

Master Bath: North Vanity Recessed (2B-03)
 Master Bath: North Vanity Bar Light (2B-08)

Cables
1 - Red

Keypad Location 2B-C
South Vanity



Master Bath: South Vanity Recessed (2B-04)
 Master Bath: South Vanity Bar Light (2B-09)

Cables
1 - Red

Keypad Location 2D-D
Master Toilet

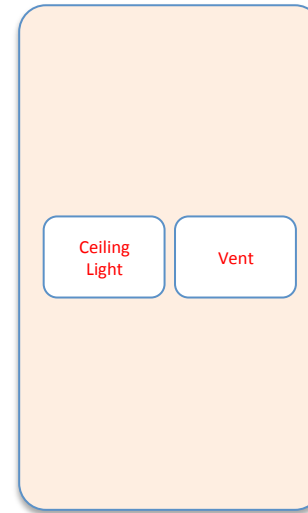

Master Toilet: Recessed Light (2B-05)
 Master Toilet: Vent Fan (2B-19)

Cables
1 - Red

Keypad Location 2B-E
Study Wet Bar

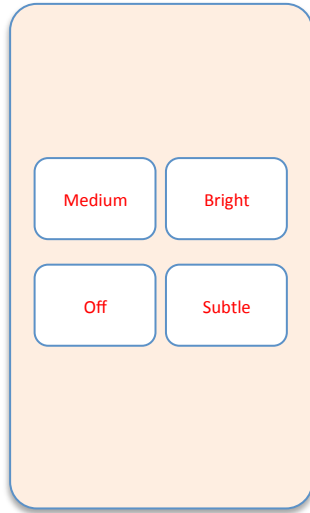

Study Wet Bar: Recessed Light (2B-01)
Study Wet Bar: Counter Light (2B-14)

Cables
1- Red

Keypad Location 2B-F
Study, West Door



Study: Window Seat (2B-02)
Study: Recessed (2B-12)
Study: Crown Lighting (2B-13)
Study: Desk Lighting (2B-15)
Study: Counter Accent Lighting (2B-31)
Study: Ceiling Fan (2B-16)

Cables
2 - Red

Keypad Location 2B-G
Study, North Door



Study: Window Seat (2B-02)
Study: Recessed (2B-12)
Study: Crown Lighting (2B-13)
Study: Desk Lighting (2B-15)
Study: Counter Accent Lighting (2B-31)
Study: Ceiling Fan (2B-16)

Cables
1 - Red

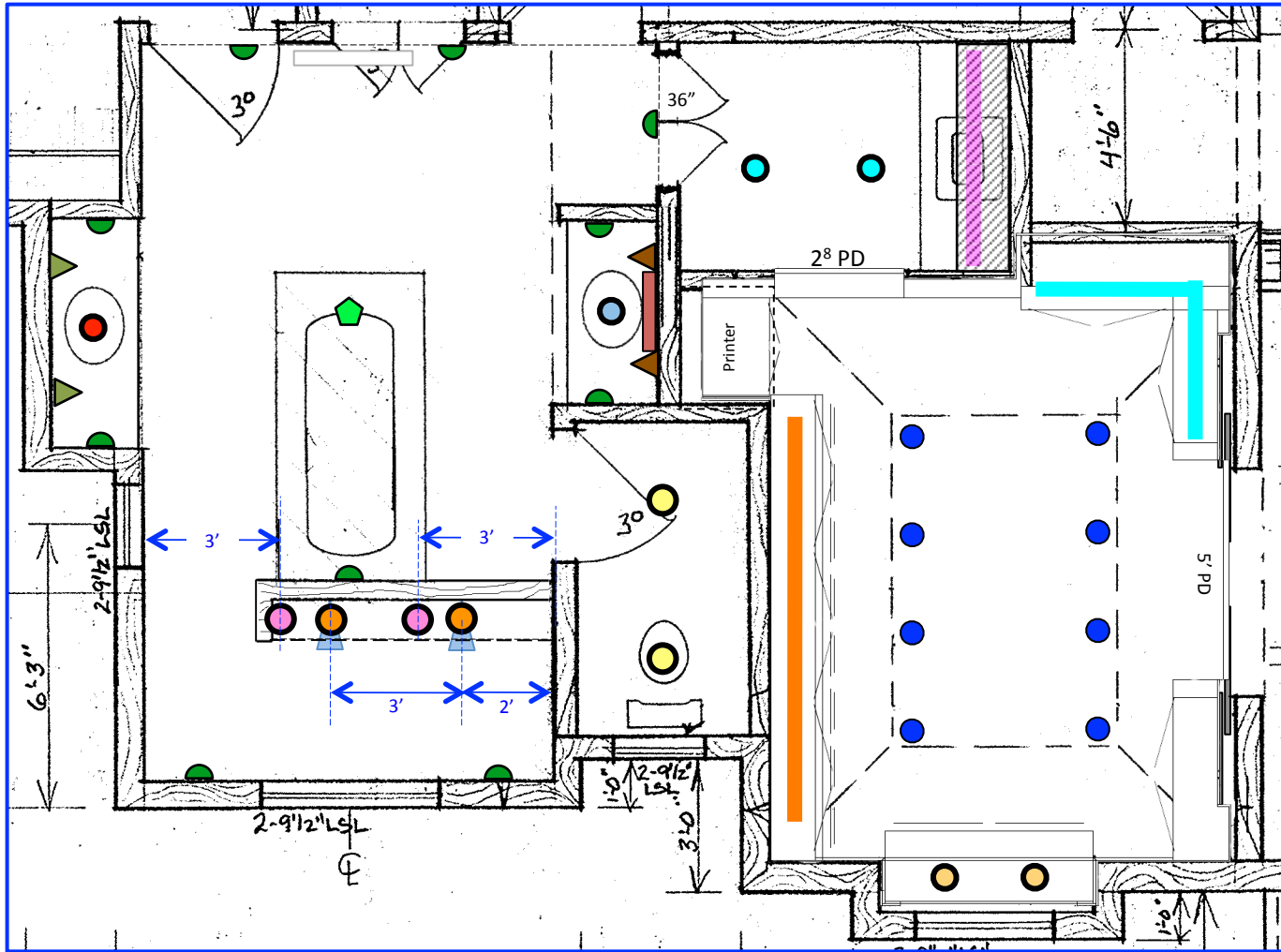



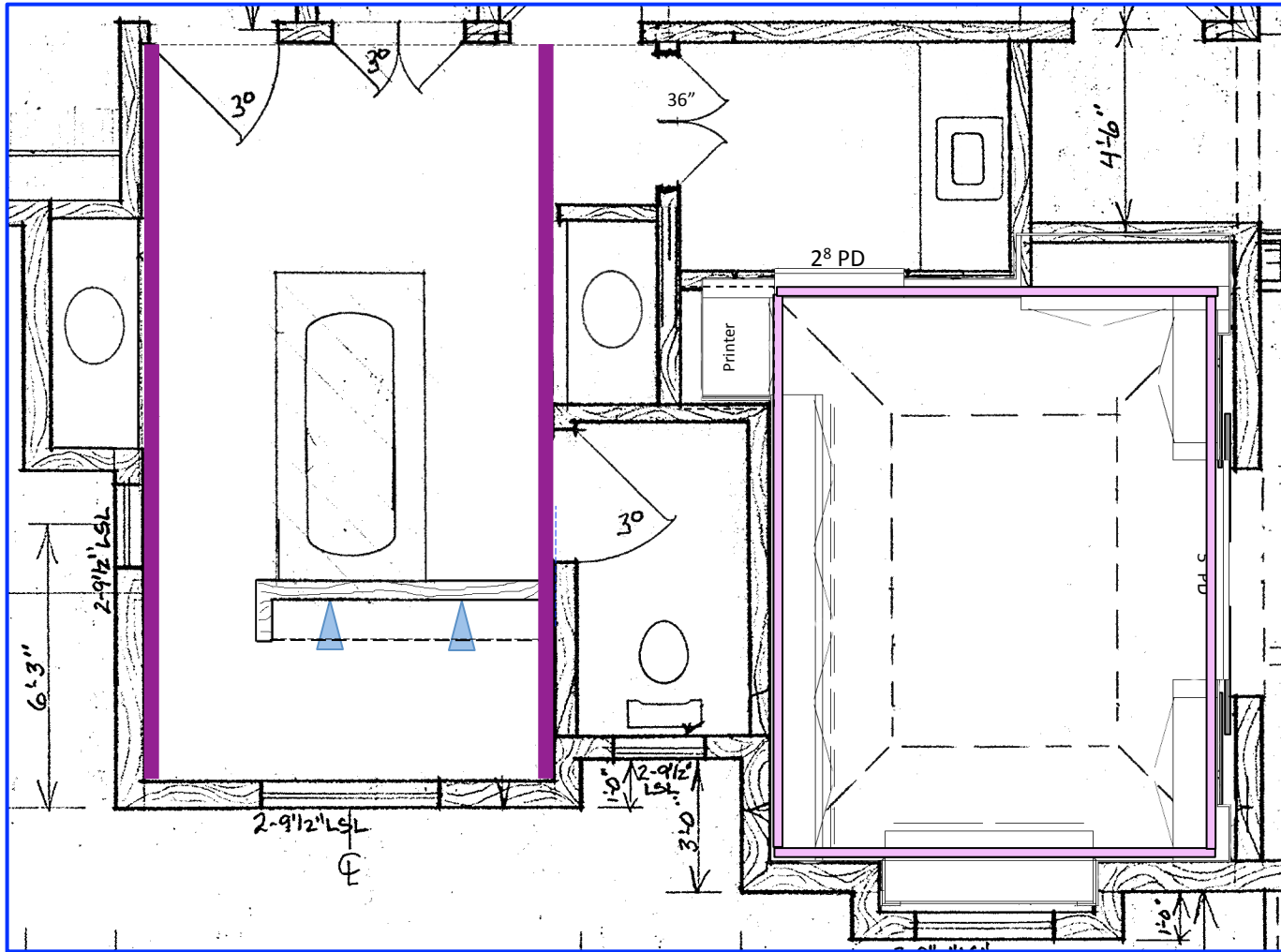

Lighting 1

Scale: 4' per inch



Lighting 2

Scale: 4' per inch

-  = 4" LED Recessed (2B-01)
-  = 4" Incand Recessed (2B-02)
-  = 5" Incand Recessed (2B-03)
-  = 5" Incand Recessed (2B-04)
-  = 4" LED Recessed (2B-05)
-  = 5" Incand Wet Recessed Ceiling Lighting (2B-06)
-  = 5" Incand Wet Recessed Shower Lighting (2B-07)
-  = 4" LED Recessed (2B-12)
-  = False Window Backlight (2B-30)
-  = Bath Crown Lighting (2B-T32) (~32 lineal ft)
-  = Vertical Bar Lighting (2B-08)
-  = Vertical Bar Lighting (2B-09)
-  = Sconce (95" Ht.) (2B-11)
-  = Chandelier (2B-10)
-  = Study Crown Lighting (2B-T13) (~40 lineal ft)
-  = Counter Lighting (2B-T14) (~5 lineal ft)
-  = Counter Lighting (2B-T15) (~8 lineal ft)
-  = Counter Accent Lighting (2B-T31) (~17 lineal ft)

Tub Controls?

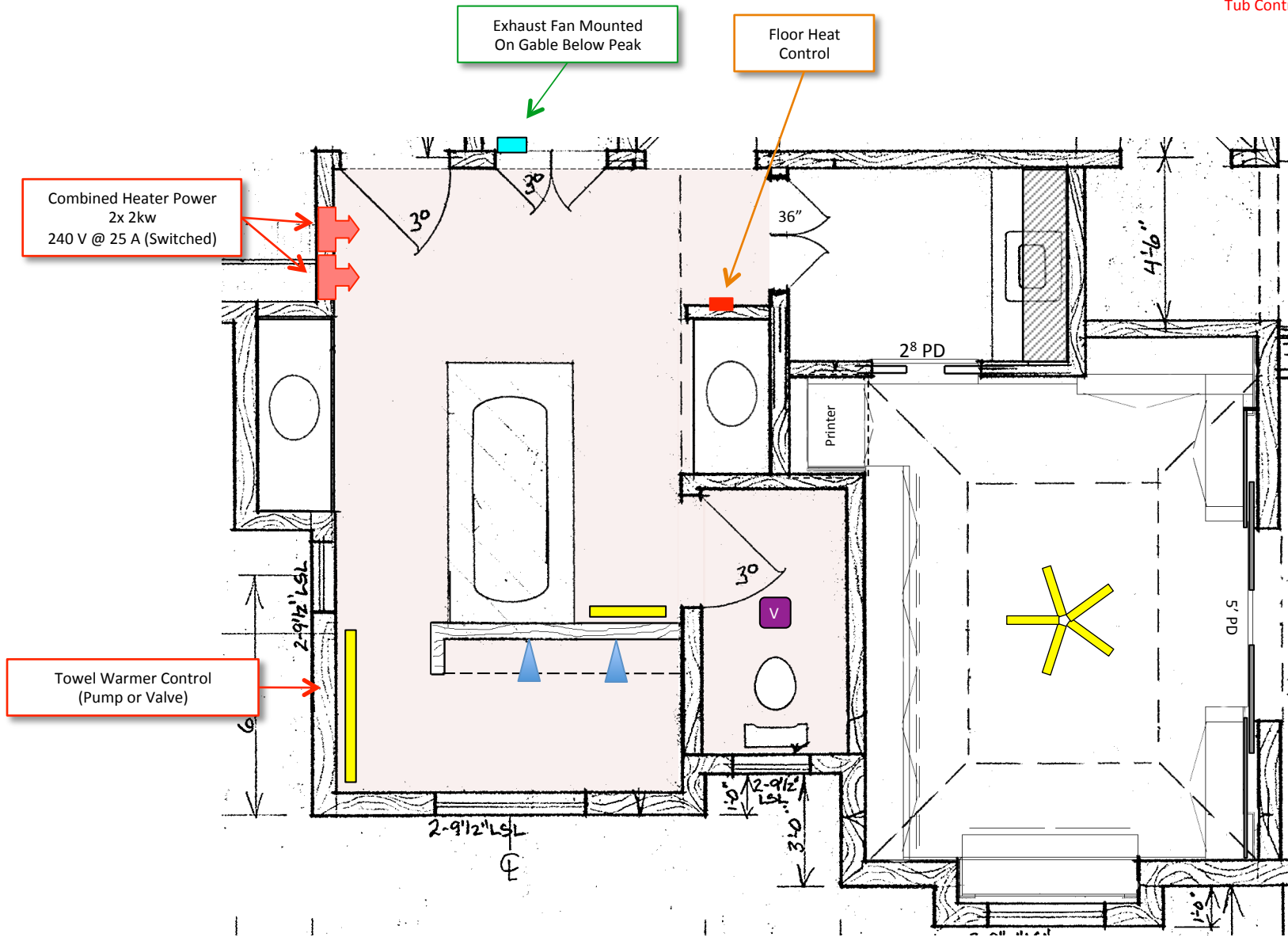

Heating & Ventilation

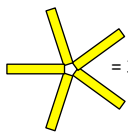

= 36" Ceiling Fan (2B-16)



= Toe-Space Forced Air Heater (1500 W each) (2B-17)



= Exhaust Fans (2B-18)



= Exhaust Fans (2B-19)



= Hydronic Towel Warmer



= Heated Floor

Scale: 4' per inch

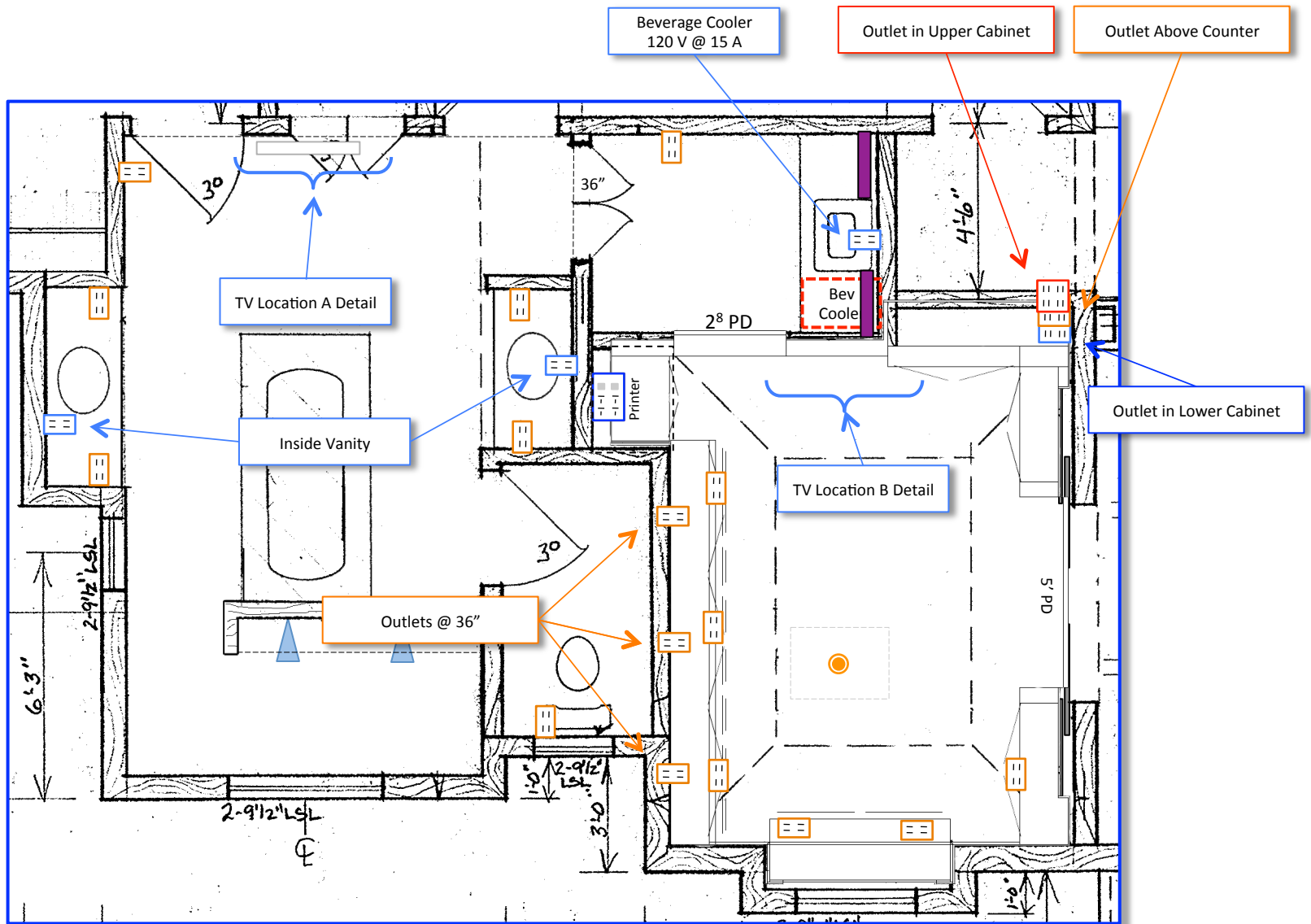







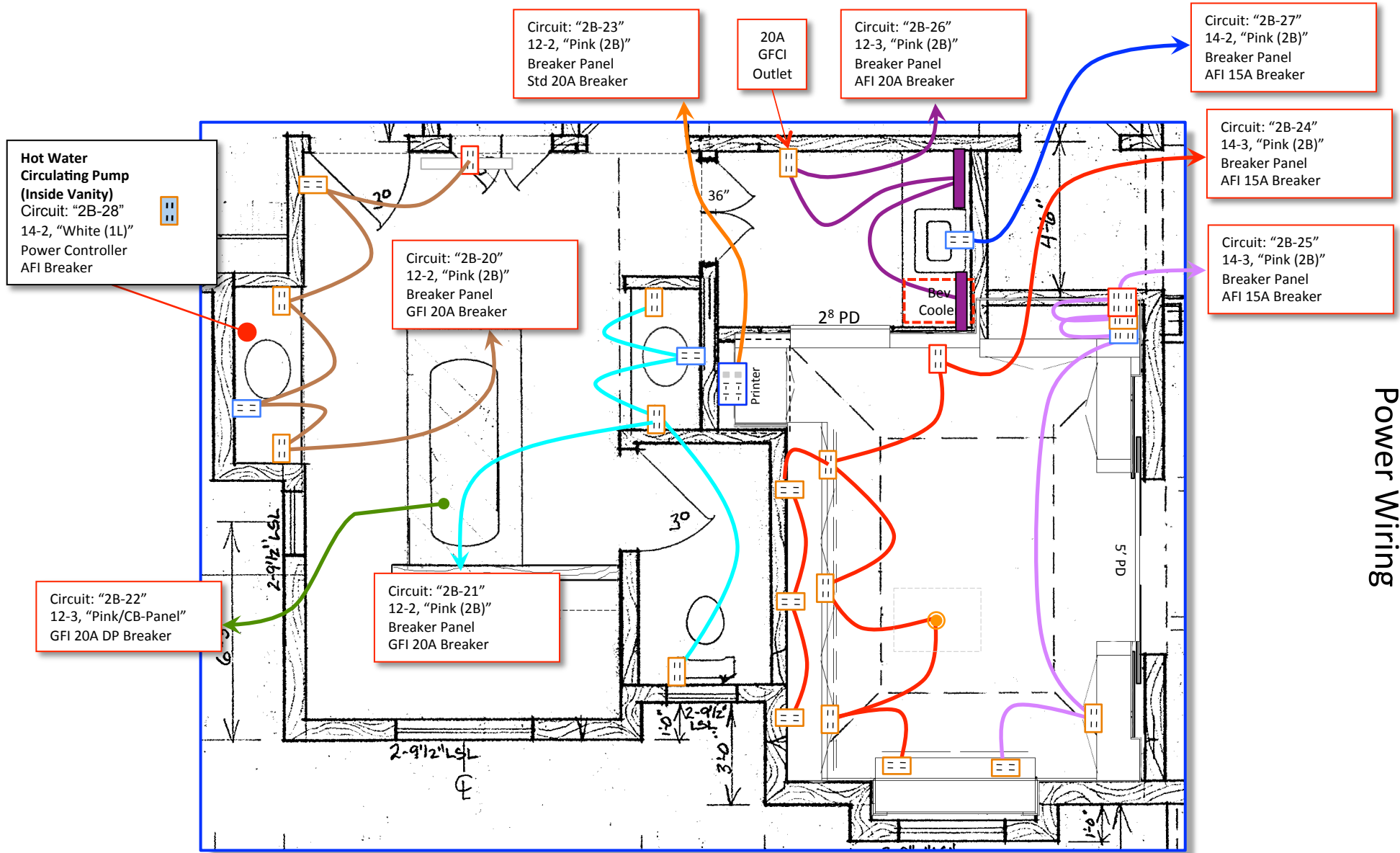



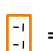
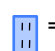

Power

- = 15A Quad
- = 15A Duplex
- = 20A Duplex
- = 20A Outlet Strip
- = 15A Duplex / LAN / Phone
- = 15A Quad / LAN / Phone (Concealed)
- = 15A Quad (Concealed)
- = 15A Duplex (Concealed)
- = 15A Duplex / LAN / Phone
- = 20A Quad / LAN / Phone (Concealed)
- = Floor (15 A Duplex/LAN/Phone)
- = 15A Quad (High)

Scale: 4' per inch

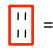

Power Wiring

-  = 15A Quad
-  = 15A Duplex
-  = 20A Duplex
-  = 15A Duplex (Switched recirc pump)
-  = 15A Duplex / LAN / Phone
-  = 15A Quad / LAN / Phone (Concealed)
-  = 15A Quad (Concealed)
-  = 15A Duplex (Concealed)
-  = 15A Duplex / LAN / Phone
-  = 20A Quad / LAN / Phone (Concealed)
-  = Floor (15 A Duplex/LAN/Phone)
-  = 15A Duplex (TV Mount)
-  = 20A Outlet Strip

Scale: 4' per inch

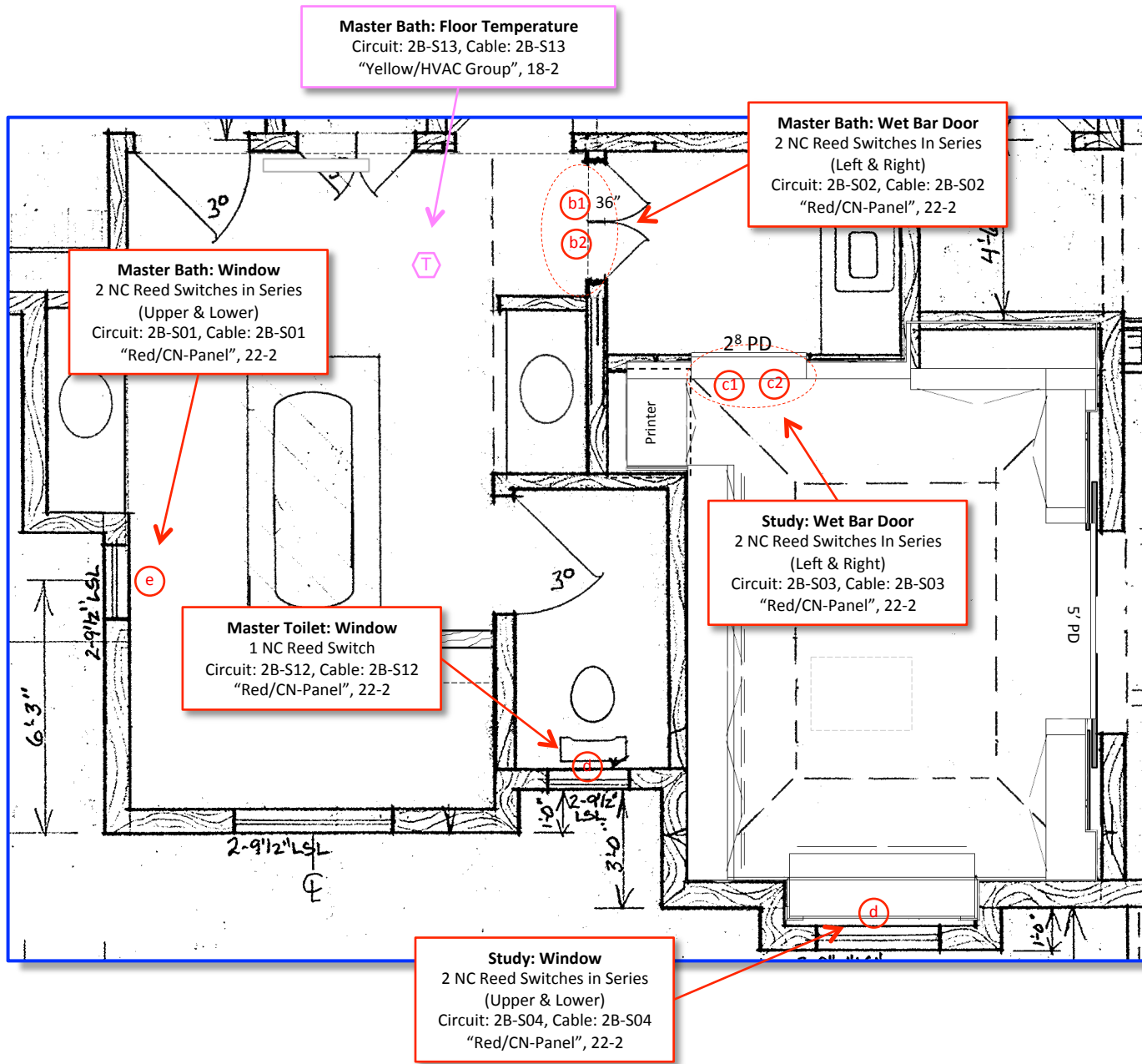

Sensors 1

(X) = NC Door/Window Sensor
(Concealed Reed)

Scale: 4' per inch

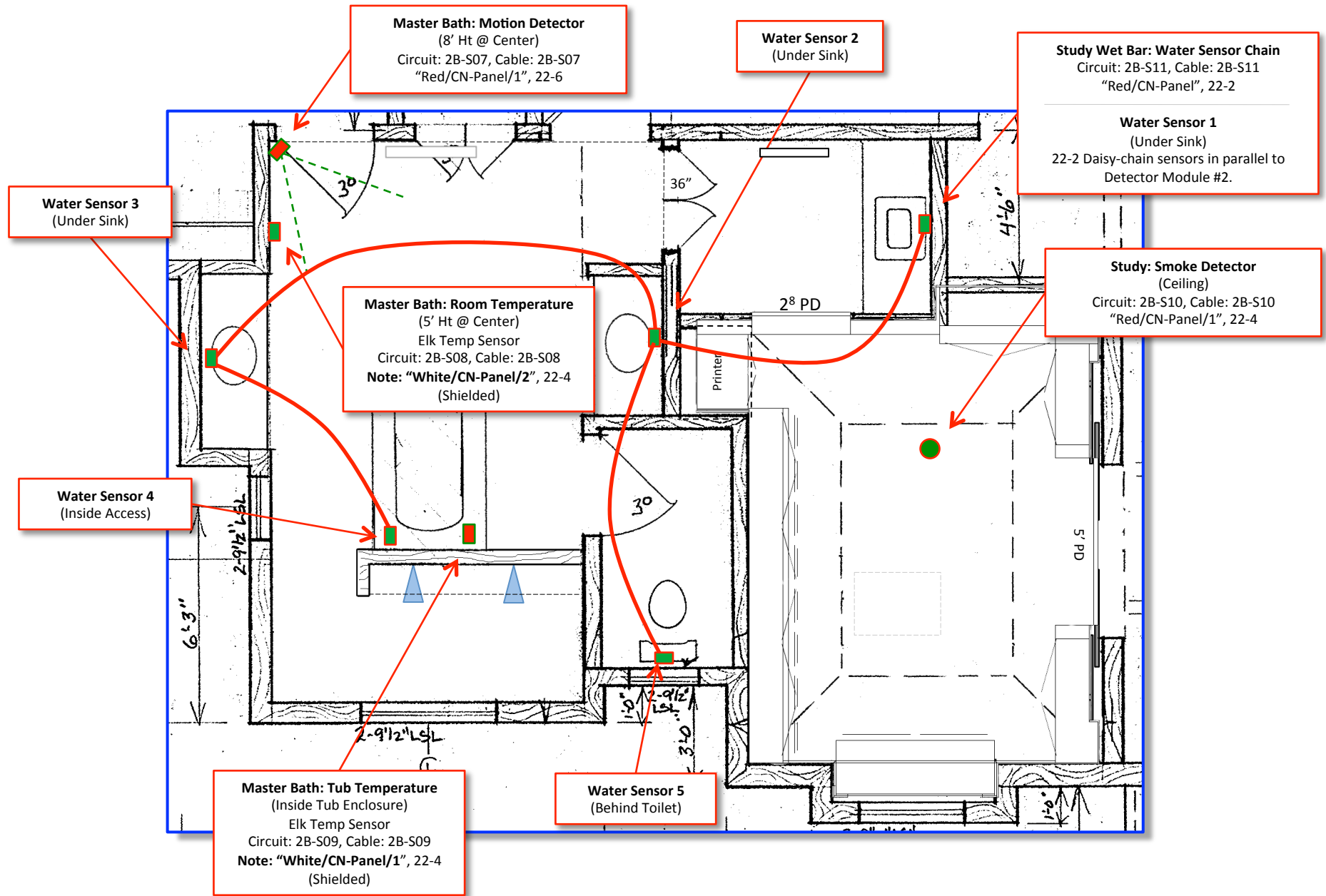

Sensors 2

Scale: 4' per inch

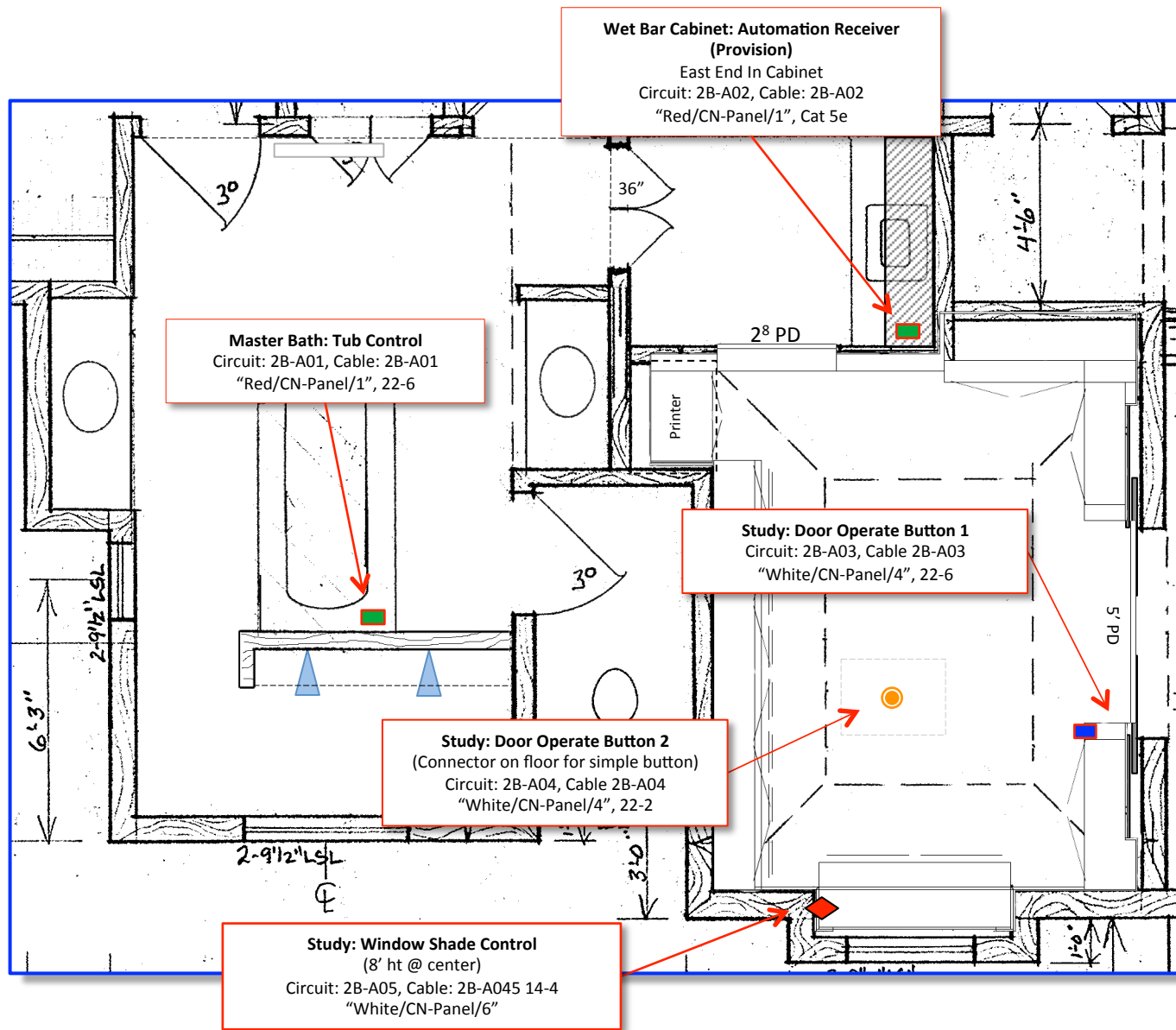

Scale: 4' per inch

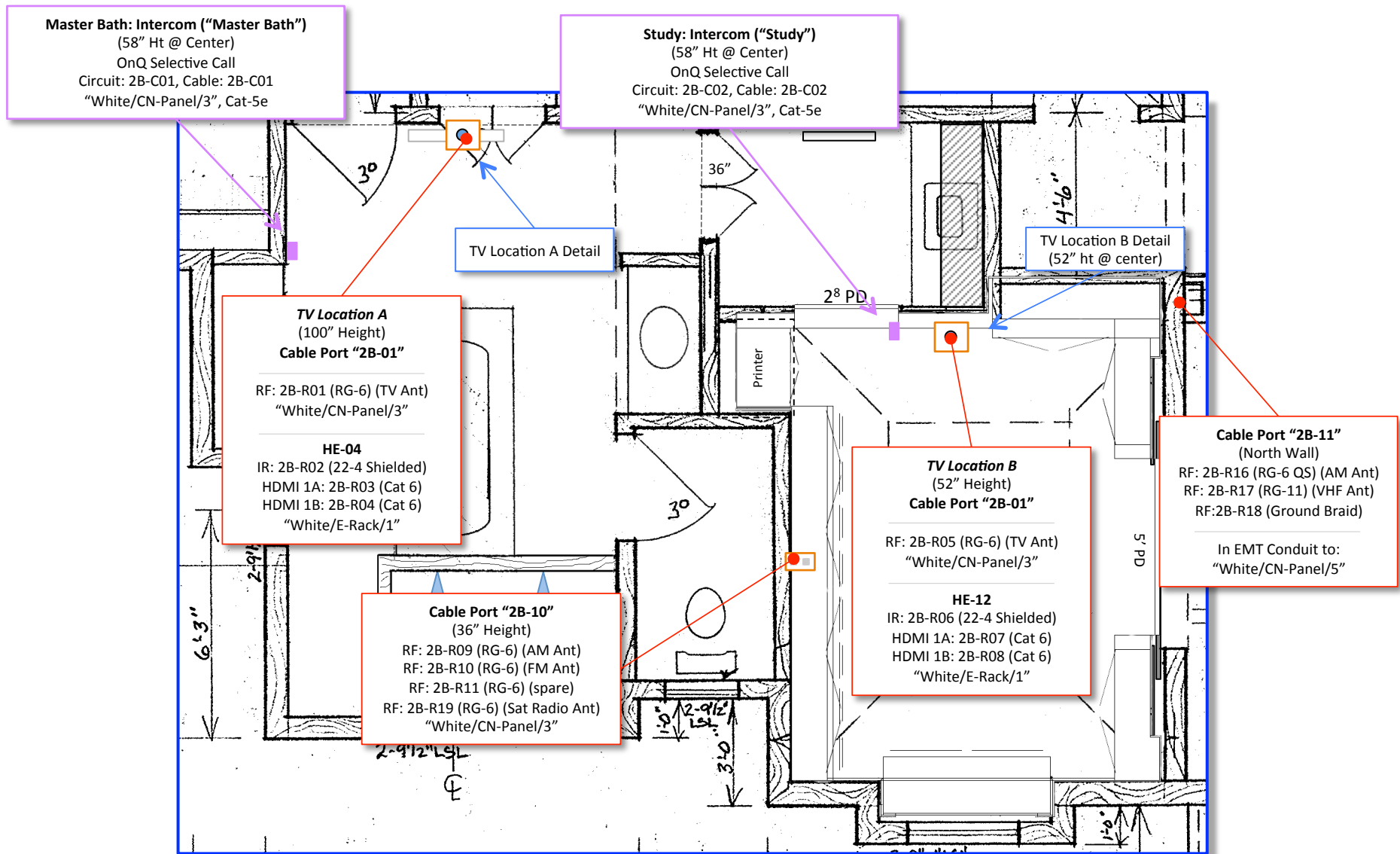

Communications 1

Scale: 4' per inch

All LAN & Phone Cables: **Cat 6, "Red/CN-Panel"**
 (Except 2B-C07: "White/Eq-Rack/3")

Wet Bar: Wireless Access Point
Cable Port "2B-04"
 West End Inside Cabinet
 (POE From White/Eq-Rack/2)
Note: LAN: 2B-C07

Cable Port "2B-05"
 (Upper-West Wall)
 LAN: 2B-C08
 Phone: 2B-C09

Cable Port "2B-06"
 (Lower-West Wall)
 LAN: 2B-C10
 spare: 2B-C11

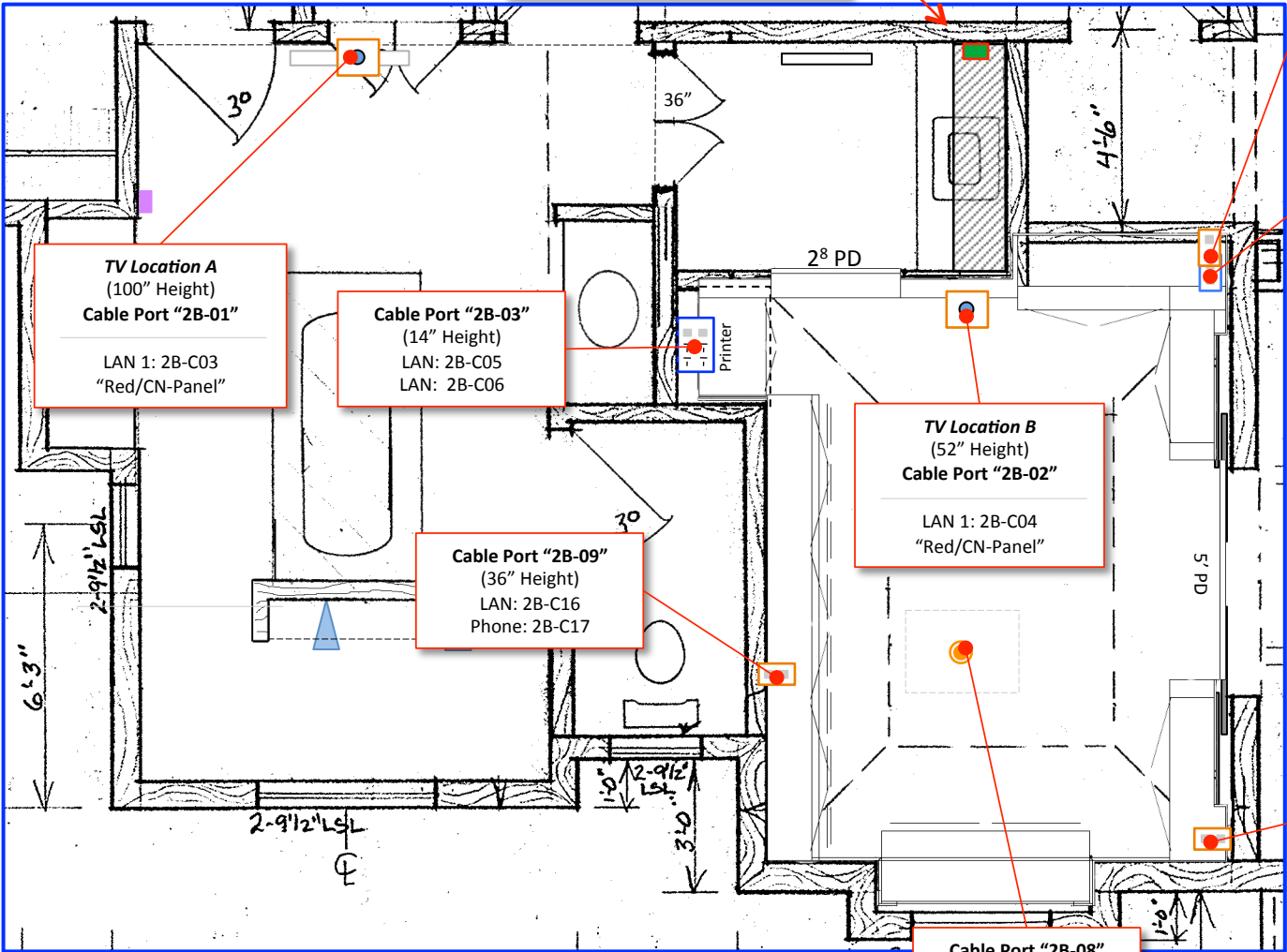

TV Location A
 (100" Height)
Cable Port "2B-01"
 LAN 1: 2B-C03
 "Red/CN-Panel"

Cable Port "2B-03"
 (14" Height)
 LAN: 2B-C05
 LAN: 2B-C06

TV Location B
 (52" Height)
Cable Port "2B-02"
 LAN 1: 2B-C04
 "Red/CN-Panel"

Cable Port "2B-09"
 (36" Height)
 LAN: 2B-C16
 Phone: 2B-C17

Cable Port "2B-08"
 (14" Height)
 LAN 1: 2B-C14
 LAN 2: 2B-C18
 Phone: 2B-C15

Cable Port "2B-07"
 (14" Height)
 LAN: 2B-C12
 Phone: 2B-C13

= LAN / Phone
 = LAN / Phone (Concealed)

= Power / LAN / Phone (Concealed)

Communications 2

Scale: 4' per inch

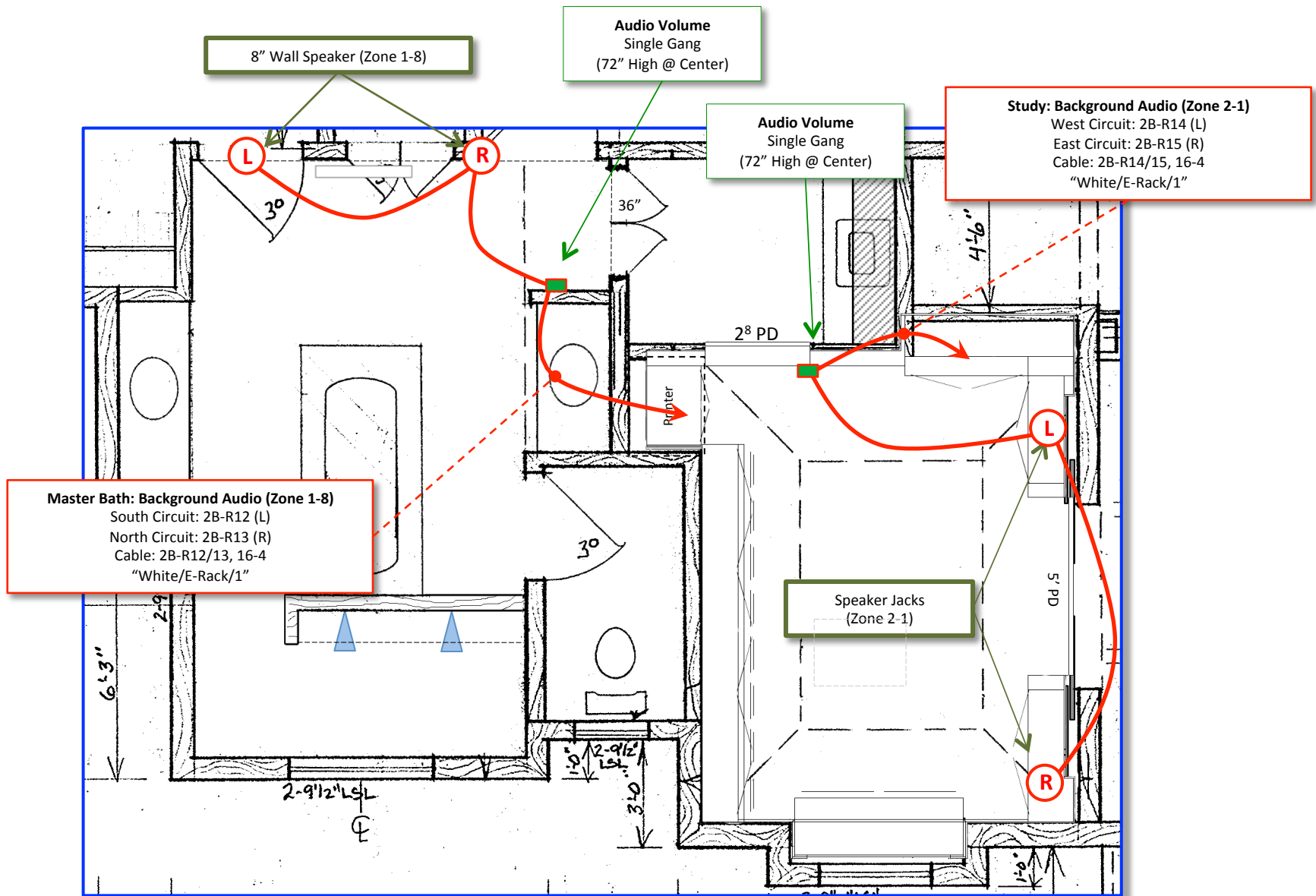

Audio

Scale: 4' per inch

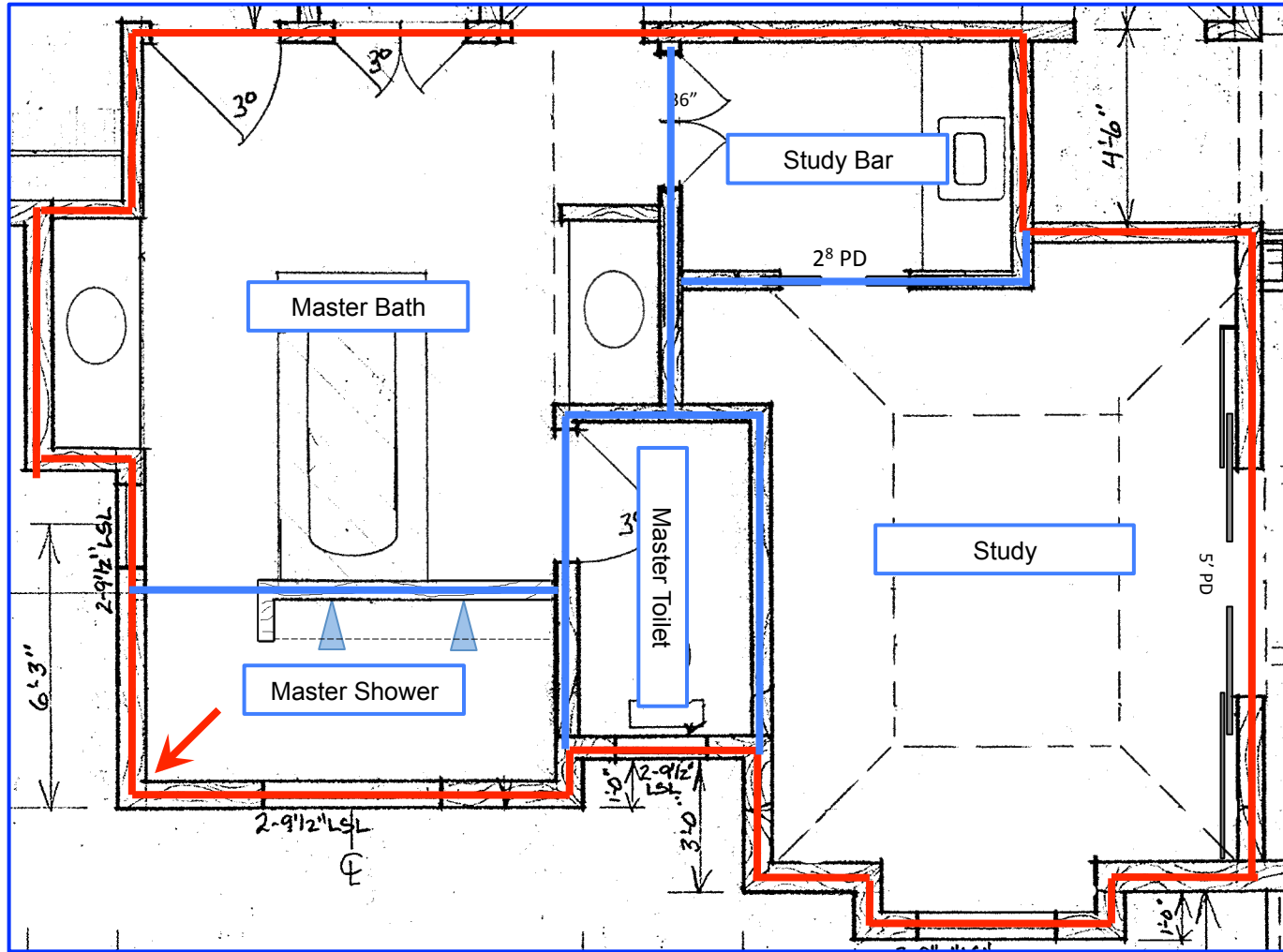

Region Overview

— = Region Boundary ↙ = Region Anchor Point (Corner)

Scale: 4' per inch

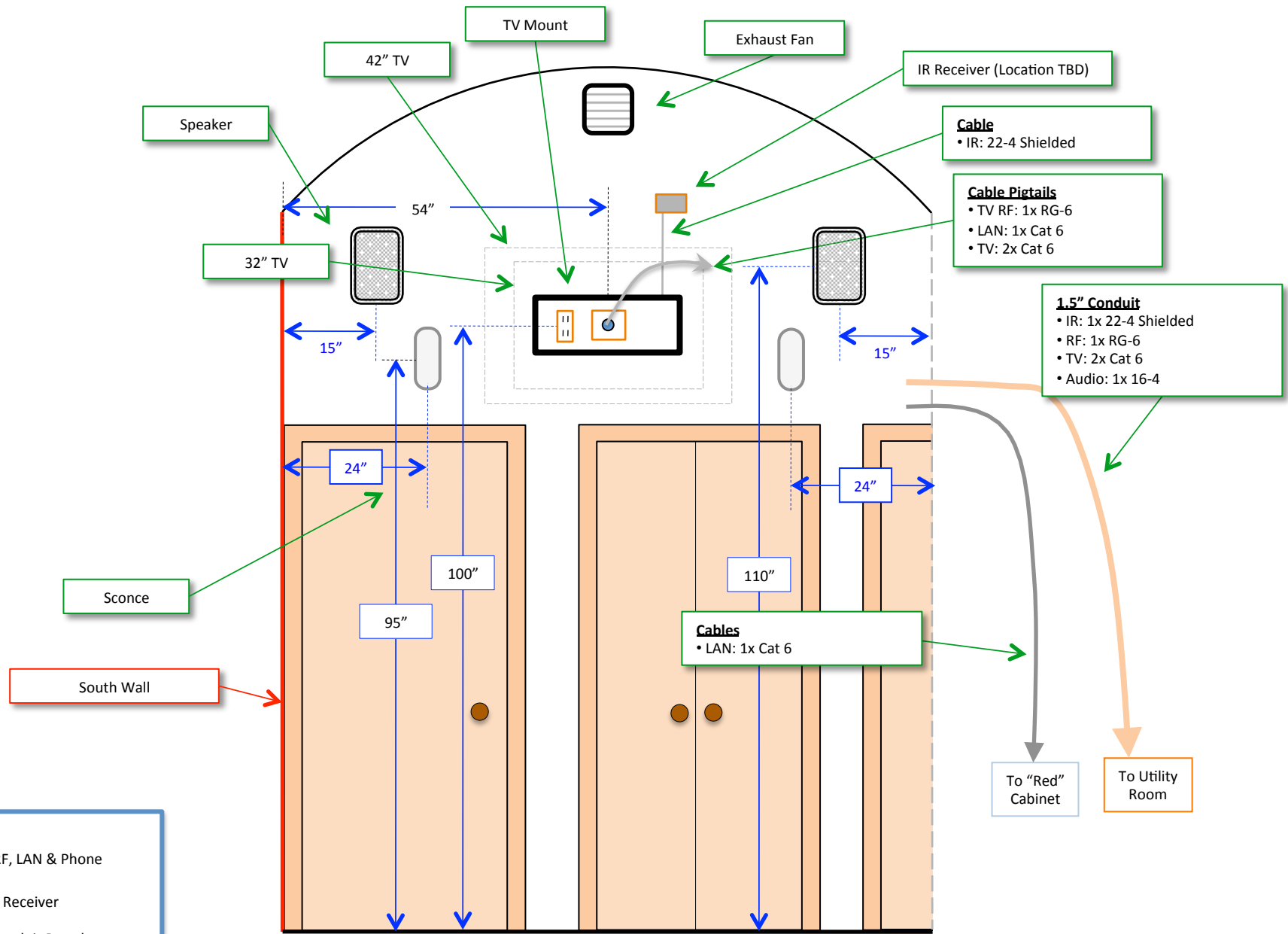

TV Location A Detail

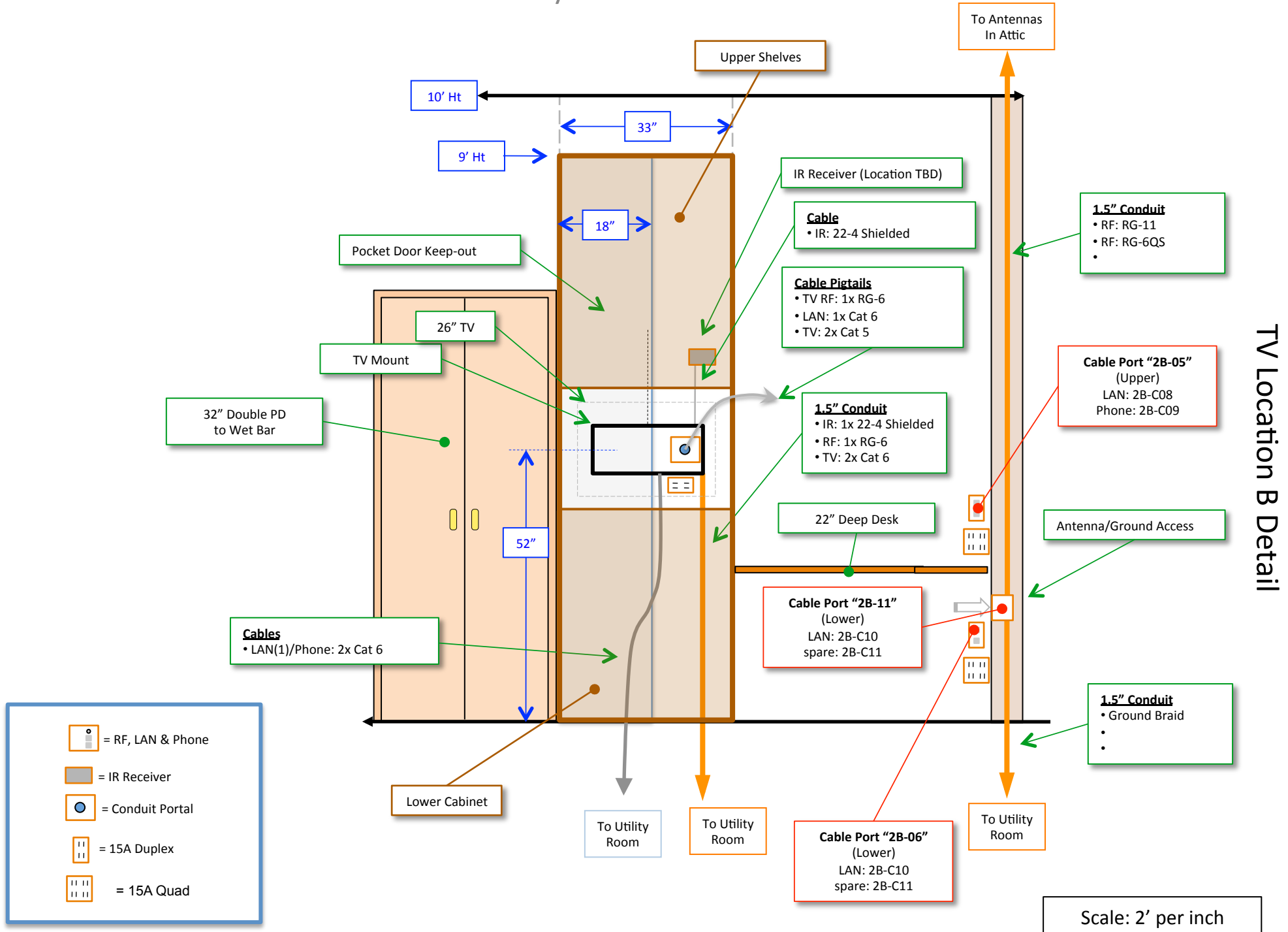

TV Location B Detail

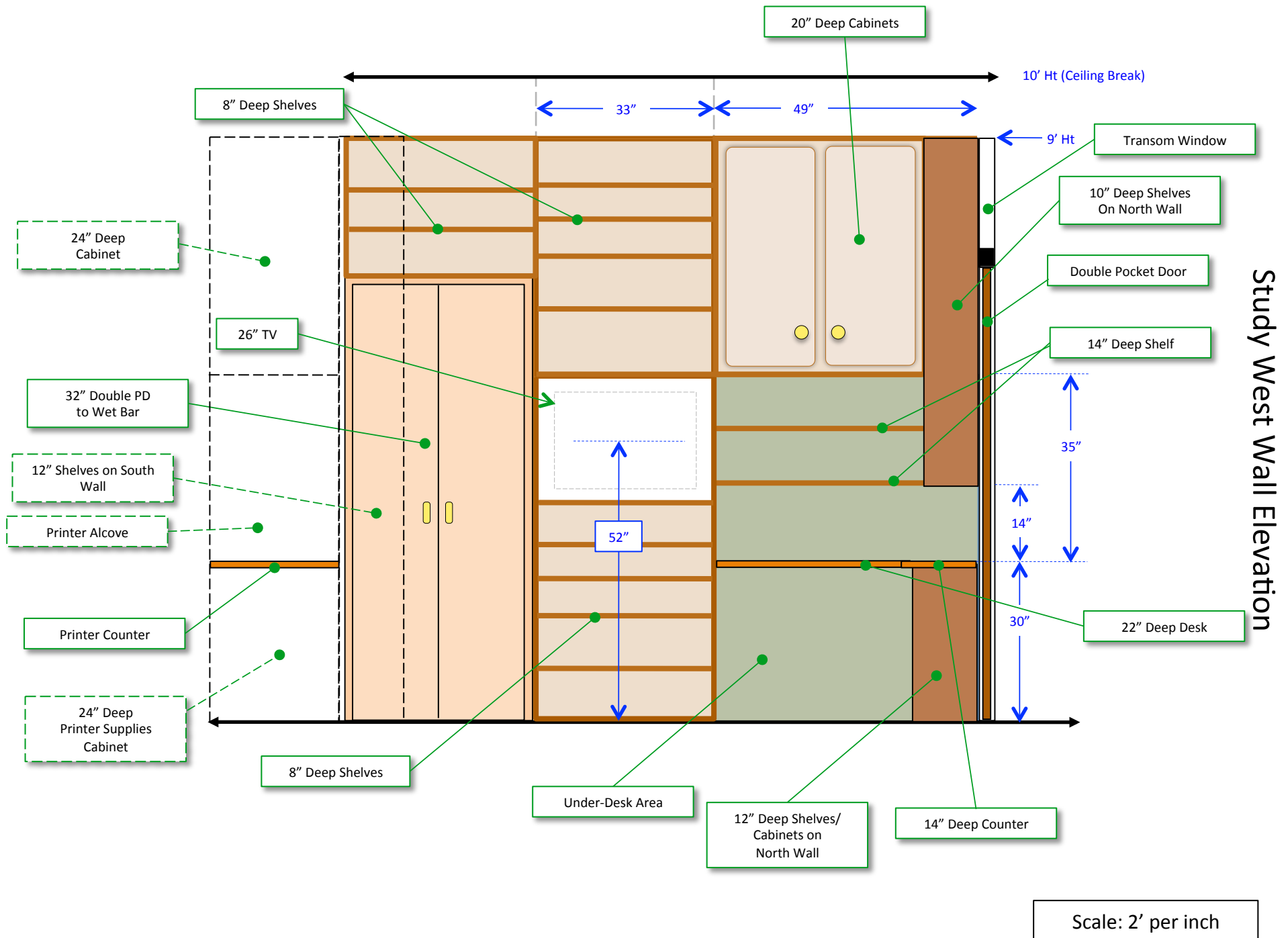

Study West Wall Elevation

Scale: 2' per inch

